

# RIVA DOMINO 88

RIVA YACHT | 2017 | 26,84 M / 88'1" FT | PRICE € 4.950.000 VAT PAID

## SPECIFICS

LENGTH: 26,84 M / 88'1" FT

BEAM: 6,29 M / 20'8" FT

YEAR: 2017

CRUISING SPEED: 24 KNOTS

MAX SPEED :40 KNOTS

ENGINES : 2638 HP,TWIN,  
2017, INBOARD, DIESEL, MTU,  
16V 2000 M9

ENGINE HOURS : 900

TONNAGE : 122

HULL MATERIAL : GRP

SUPERSTRUCTURE : GRP

FUEL CAPACITY: 7500 L

WATER CAPACITY: 900 L

HOLDING TANK: 660 L

FLAG: MALTA

## HABITABILITY

STATEROOMS: 4

GUEST SLEEPING: 9

HEADS: 4

CREW QUARTERS: 2

CREW BERTHS: 4

INT DESIGN: MAURO MICHELI

– OFFICINA ITALIANA DESIGN

EXT DESIGN: MAURO MICHELI

– OFFICINA ITALIANA DESIGN

# RIVA DOMINO 88

RIVA YACHT | 2017 | 26,84 M / 88'1" FT | PRICE € 4.950.000 VAT PAID

## MAIN CHARACTERISTICS

### **GUEST ACCOMMODATION**

7 BEDS IN 4 CABINS (SLEEPING 9) – 1 x MASTER, 1 x VIP, 1 x STARBOARD TWIN WITH PULLMAN, 1 PORT DOUBLE/SLIDING TWIN BED CONVERSION.

CREW ACCOMMODATION: 2 BUNK BEDS IN 2 CABINS SLEEPING 4.

HULL & TECHNICAL DESIGN: FERRETTI GROUP

YACHT DESIGN: MAURO MICHELI – OFFICINA ITALIANA DESIGN

# RIVA DOMINO 88

RIVA YACHT | 2017 | 26,84 M / 88'1" FT | PRICE € 4.950.000 VAT PAID

## MACHINERY

### **MAIN ENGINES**

2 x MTU 16V 2000 SERIES M94 RATED AT 2638 MHP EACH PORT – 963 HOURS  
STBD – 965 HOURS

### **GENERATORS**

2 x KOHLER 27KW 50HZ DIESEL GENERATORS  
PORT – 2095 HOURS  
STBD – 2096 HOURS

### **TANKS CAPACITIES**

FRESH WATER: 900 LITRES (237 US GALS)  
BLACK WATER: 330 LITRES (87 US GALS )  
GREY WATER: 330 LITRES (87 US GALS)

# RIVA DOMINO 88

RIVA YACHT | 2017 | 26,84 M / 88'1" FT | PRICE € 4.950.000 VAT PAID

## ANCILLARY EQUIPMENT

STABILISERS: GYRO STABILISER – 2 X SEAKEEPER SERIES 9, LOCATED AFT END OF ENGINE ROOM BOW / STERN  
THRUSTERS: TRAC , HYDRAULIC

AIR CONDITIONING: SUPER TROPICAL AIR CONDITIONING UPGRADE – DOMETIC / CONDARIA, 180,000 BTU  
SUPPLIED BY TWO 90,000 BTU CHILLERS.

ENGINE ROOM VENTILATION: GIANNESCHI FANS.

WATER MAKER: IDROMAR - PRODUCING 180L/H

BOILERS: 2 X ELECTRIC 80 LITRE 1.2KW

TOILETS: PLANUS – MARINE TOILET VORTEX SYSTEM.

# RIVA DOMINO 88

RIVA YACHT | 2017 | 26,84 M / 88'1" FT | PRICE € 4.950.000 VAT PAID

## ELECTRICAL EQUIPMENT

SHORE POWER: 1 x 63A SHORE POWER CONNECTION WITH CABLE. SOCKETS: EUROPEAN & USB SOCKETS FITTED TO THE INTERIOR

LIGHTING:

INTERIOR & EXTERIOR LED LIGHTING

DIMMER SWITCHES FITTED TO INTERIOR AND COCKPIT CEILING LIGHTING. NOTE THEY ARE NOT INSTALLED IN THE ENSUITES AND CREW AREA.

BLINDS & CURTAINS: MANUAL CONTROL THROUGHOUT THE INTERIOR.

UNDERWATER LIGHTS: 6 x OCEAN LED LIGHTS IN WHITE, TWO ACROSS THE STERN AND TWO EITHER SIDE. STERN

SALOON DOOR: MANUAL

BRIDGE DOOR: PORT SIDE ELECTRIC OPENING AND LOCKING DOOR

# RIVA DOMINO 88

RIVA YACHT | 2017 | 26,84 M / 88'1" FT | PRICE € 4.950.000 VAT PAID

## DECK EQUIPMENT

ANCHOR WINDLASS: 2 X LOFRAN'S PROJECT X4 VERTICAL GYPSY AND CAPSTAN DRUM, 2700W, 24V.

ANCHORS:

2 X STAINLESS STEEL POLISHED ANCHORS: STARBOARD SIDE 50KG

PORT SIDE 35KG

CHAIN:

STARBOARD SIDE - 100 METRES, 12 MM GALVANISED CHAIN. PORT SIDE - 65 METRES, 12 MM GALVANISED CHAIN.

STERN CAPSTANS: TWO LOFRANS 24V VERTICAL CAPSTANS (1 ON BOTH THE PORT AND STARBOARD SIDE)

PASSERELLE: BESENZONI, POLISHED STAINLESS STEEL.

SWIM PLATFORM: HYDRAULIC LIFTING PLATFORM

SWIM SHOWER: RETRACTABLE SHOWER LOCATED ON THE PORT SIDE AFT

SWIM LADDER:

2 X SWIM LADDERS LOCATED ON THE PLATFORM. PORT SIDE, CONCEALED ELECTRO-HYDRAULIC STAINLESS-STEEL LADDER, STARBOARD SIDE MANUAL

WASHDOWN DECK CONNECTIONS: DECK WASH FEED LOCATED IN THE STEP RISER LOCKER IN THE PORT SIDE STEPS TO THE COCKPIT.

# RIVA DOMINO 88

RIVA YACHT | 2017 | 26,84 M / 88'1" FT | PRICE € 4.950.000 VAT PAID

## NAVIGATION EQUIPMENT

RADAR: FURUNO

CHART PLOTTER:

2 X FURUNO NAVNET 3D PLOTTERS AT MAIN HELM (KEYBOARD CONTROL) 1 X FURUNO TOUCH SCREEN DISPLAY AT SPORTS BRIDGE HELM

SPEED LOG: SIMRAD

AUTO PILOT: SIMRAD

COMPASS: RIVERA SRL, URANIA MAGNETIC COMPASS

GPS: SIMRAD

AIS: FURUNO CLASS B - TX-FX FA 50

HELM SCREENS: 3 X 19" MASTERS DISPLAYS AT THE MAIN HELM AND 1 FURUNO TOUCH SCREEN DISPLAY ON THE SPORTS FLYBRIDGE VHF PRIMARY / SECONDARY: SIMRAD HS90

PORTABLE RADIO (CREW): 4 X VHF, ICOM IC-M25

YACHT MONITORING & CONTROL: 19" MASTERS TOUCH SCREEN AT MAIN HELM WITH A 15" DISPLAY IN THE CREW DINETTE.

CCTV: RECORDING SYSTEM FOR CCTV – WITH CAMERAS LOCATED IN THE ENGINE ROOM, COCKPIT AND LOWER LOBBY.

NIGHT VISION CAMERA: FLIR

FIRE DETECTION SYSTEM: INSTALLED IN THE ENGINE ROOM AND CREW AREA. ENGINE ROOM FITTED WITH FM-200 MARINE FIRE SUPPRESSION SYSTEM.

# RIVA DOMINO 88

RIVA YACHT | 2017 | 26,84 M / 88'1" FT | PRICE € 4.950.000 VAT PAID

## WHITE GOODS

### MAIN DECK GALLEY

HOB: MIELE INDUCTION

COMBINED MICROWAVE/OVEN: MIELE

DISHWASHER: BOSCH SLIM LINE

FRIDGE/FREEZER: AMERICAN STYLE WITH ICE DISPENSER AND WATER FILTER. MANUFACTURED BY MABE

### COCKPIT

WETBAR: ISOTHERM ICEMAKER ON THE STARBOARD SIDE WITH BASIN AND CERAMIC HOT PLATE ON PORT SIDE.

### MAIN DECK SALOON

FRIDGE: VITRIFRIGO LOCATED ON THE STARBOARD SIDE WITH CROCKERY STOWAGE.

### CREW AREA

COMBINED WASHER / DRYER: HOOVER (LOCATED IN THE CREW MESS) FRIDGE:

VITRIFRIGO INSIDE UNDERCOUNTER UNIT.

WORKTOP WITH STAINLESS STEEL SINK AND HOTPLATE.



# RIVA DOMINO 88

RIVA YACHT | 2017 | 26,84 M / 88'1" FT | PRICE € 4.950.000 VAT PAID

## AUDIO VISUAL, SATELLITE TV & COMMUNICATIONS

SATELLITE TV 1 x KVH TV6 (WITH EMPTY DOME FOR SYMMETRY ON OPPOSITE SIDE OF ARCH) (DECODERS WILL NOT BE SUPPLIED WITH YACHT)

### AV BY AREA

SPORTS FLYBRIDGE

SATELLITE TV 1 x KVH TV6 (WITH EMPTY DOME FOR SYMMETRY ON OPPOSITE SIDE OF ARCH) (DECODERS WILL NOT BE SUPPLIED WITH YACHT)

### FORE DECK

SPEAKERS 2 x JL AUDIO SPEAKER WITH INDEPENDENT VOLUME CONTROL CONNECTED TO THE SALOON AUDIO

### AFT COCKPIT

SPEAKERS 2 x JL AUDIO SPEAKER WITH INDEPENDENT VOLUME CONTROL CONNECTED TO THE SALOON AUDIO

# RIVA DOMINO 88

RIVA YACHT | 2017 | 26,84 M / 88'1" FT | PRICE € 4.950.000 VAT PAID

## MAIN DECK SALOON

TV 43 INCH SONY BRAVIA  
DVD HARMAN KARDON BDS 580 BLU-RAY DISC SYSTEM  
SPEAKERS 4 SONANCE SPEAKERS WITH SUBWOOFER  
SATELLITE SPACE FOR DECODER  
CONTROL HANDHELD SYSTEM REMOTE CONTROL

## MASTER STATEROOM

TV 55 INCH SAMSUNG  
DVD PLAYER HARMAN KARDON BDS 580 BLU-RAY DISC SYSTEM  
SPEAKERS CONCEALED CEILING SPEAKERS  
SATELLITE SPACE FOR DECODER  
CONTROL HANDHELD SYSTEM REMOTE CONTROL

# RIVA DOMINO 88

RIVA YACHT | 2017 | 26,84 M / 88'1" FT | PRICE € 4.950.000 VAT PAID

## FORWARD VIP DOUBLE CABIN

TV 22 INCH SAMSUNG

SPEAKERS 2 CEILING SPEAKERS

AUDIO FUSION MS – AV650 (BLUE TOOTH) PLAYER.

CONTROL TV LINKED TO SYSTEM IN SALOON WITH REMOTE CONTROL

## PORT DOUBLE GUEST CABIN

TV 50 INCH SAMSUNG

SPEAKERS 2 CEILING SPEAKERS

AUDIO FUSION MS – AV650 (BLUE TOOTH) PLAYER.

CONTROL TV LINKED TO SYSTEM IN SALOON WITH REMOTE CONTROL

# RIVA DOMINO 88

RIVA YACHT | 2017 | 26,84 M / 88'1" FT | PRICE € 4.950.000 VAT PAID

## STARBOARD TWIN GUEST CABIN

TV 22 INCH SAMSUNG  
SPEAKERS 2 CEILING SPEAKERS  
AUDIO FUSION MS – AV650 (BLUE TOOTH) PLAYER.  
CONTROL TV LINKED TO SYSTEM IN SALOON WITH REMOTE CONTROL

## GALLEY/CREW MESS

TV 22 INCH SAMSUNG (CEILING MOUNT, HINGED)  
SPEAKERS 2 CEILING SPEAKERS  
AUDIO FUSION MS – AV650 (BLUE TOOTH)

# RIVA DOMINO 88

RIVA YACHT | 2017 | 26,84 M / 88'1" FT | PRICE € 4.950.000 VAT PAID

## WIFI & 5G SYSTEM

PEPWAVE MARINE WIFI SYSTEM.

## TENDERS & TOYS

MAIN TENDER WILLIAMS 385 TURBO JET – WITH 117 HOURS USE. WITH INDEPENDENT QUICK

## FURTHER UPGRADES OF NOTE

- AFT DOCKING CONTROL STATION WITH ENGINE CONTROL, BOW AND STERN THRUSTER CONTROL AND START
- STOP PANEL PER ENGINE - DIGITAL SAFES IN ALL GUEST CABINS AND IN CREW AREA.
- TEAK DECKING IN ALL EXTERIOR AREAS.
- WASH AND GO DOCK FRESH WATER PURIFICATION SYSTEM.
- OIL CHANGE SYSTEM FOR ENGINES, GEARBOXES AND GENERATORS

# RIVA DOMINO 88

RIVA YACHT | 2017 | 26,84 M / 88'1" FT | PRICE € 4.950.000 VAT PAID

***\*THIS DOCUMENT CANNOT BE CONSIDERED CONTRACTUAL IN ANY WAY. IT IS GIVEN FOR INFORMATION PURPOSES ONLY.***































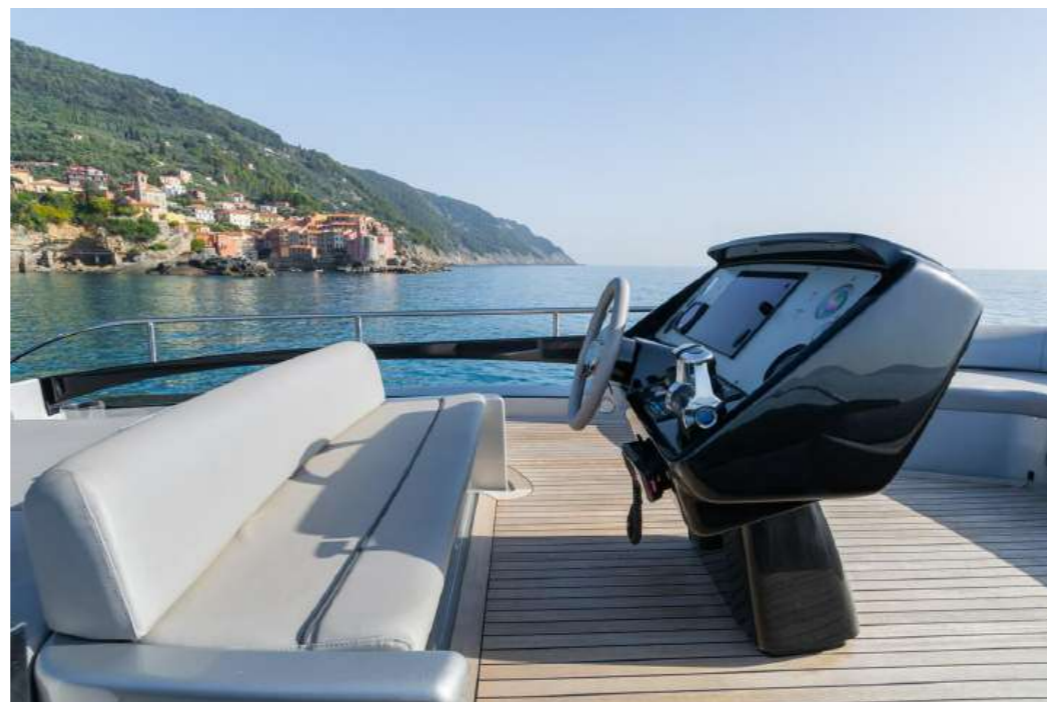























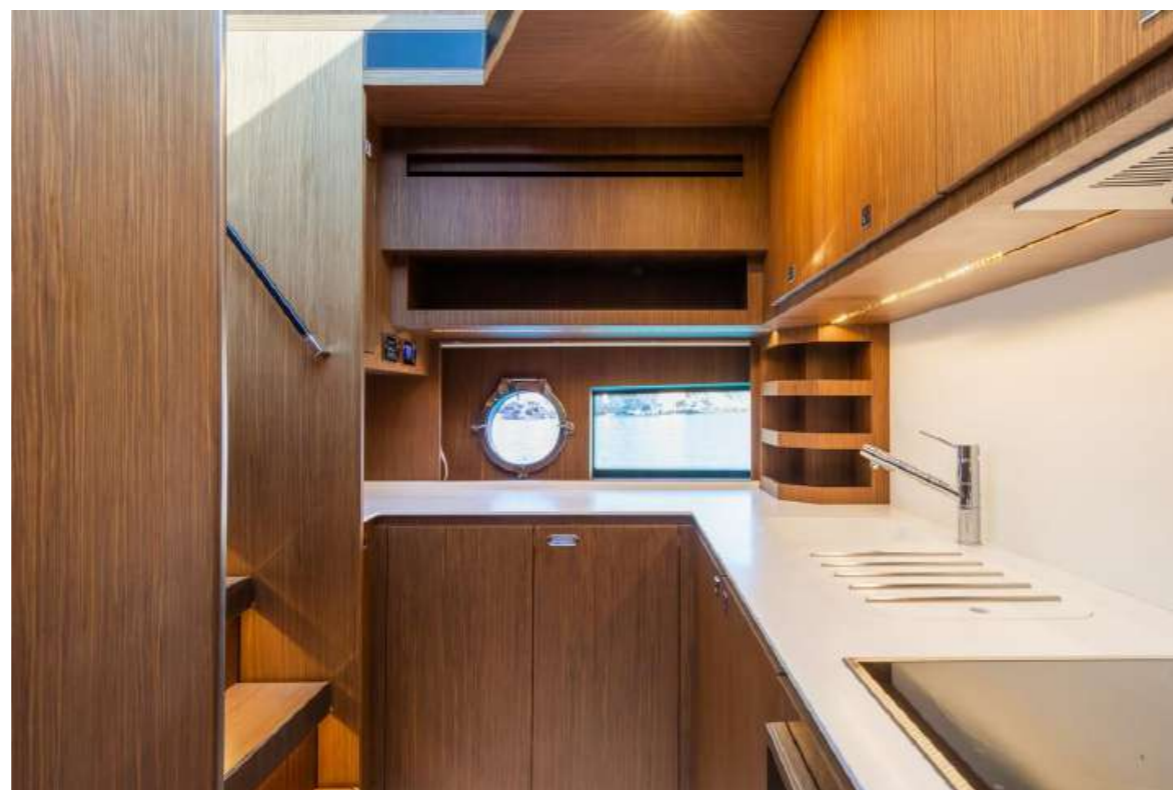
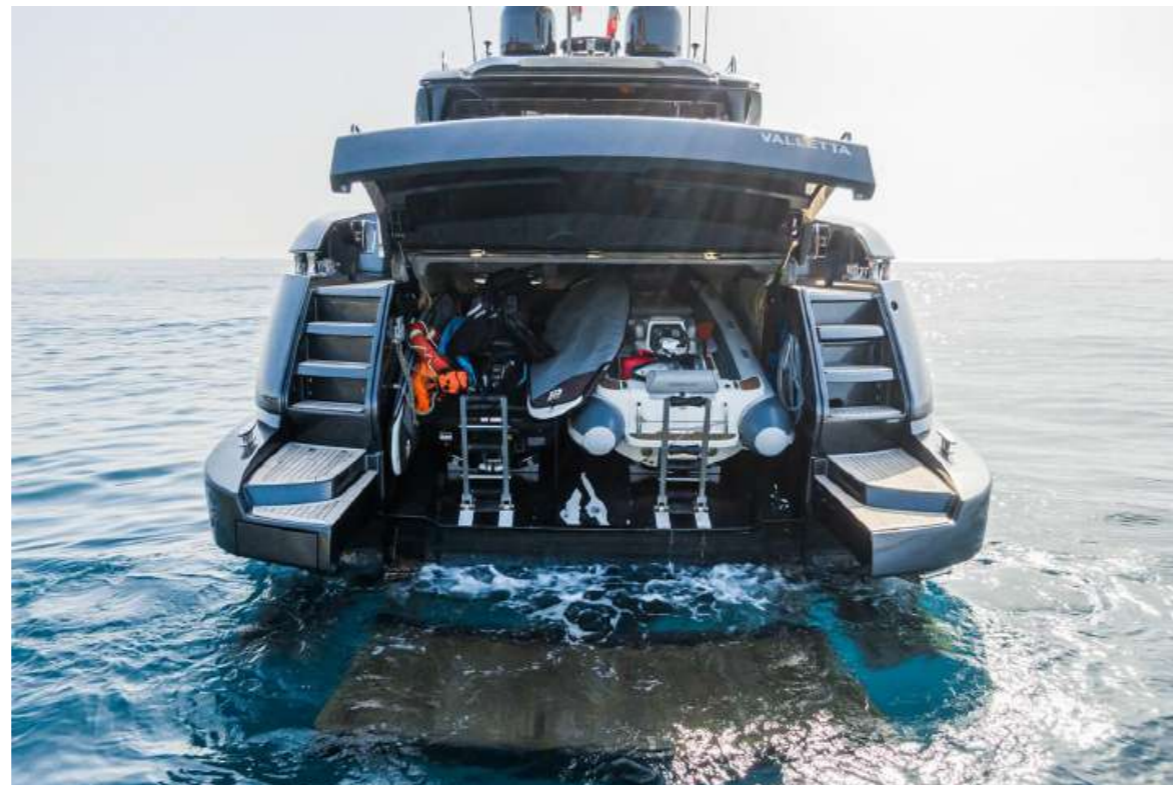







Profile

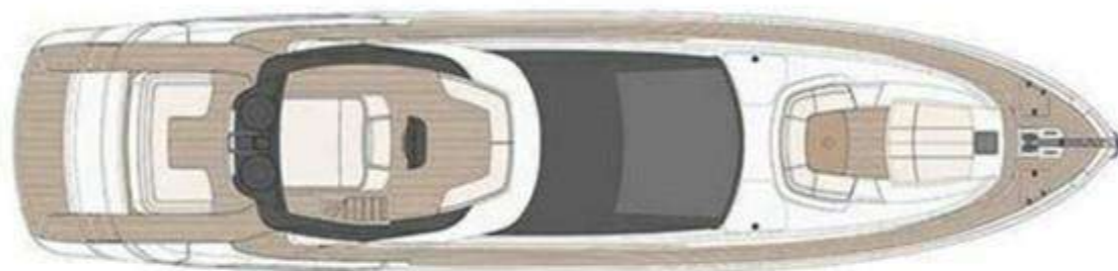

Sun deck

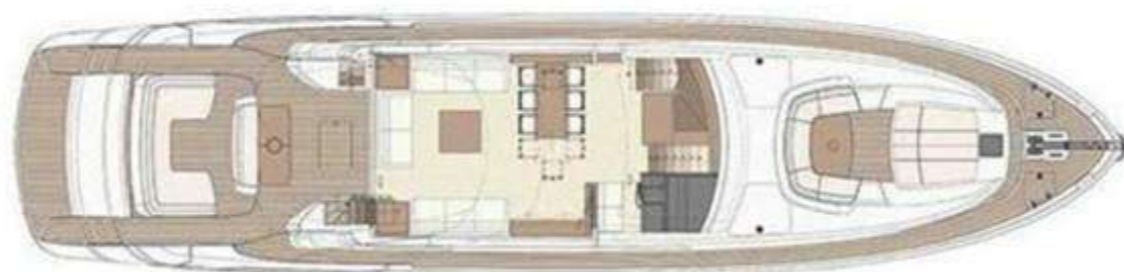

Main deck



Lower deck